

# Flat top

**Azman Owens Architects raises its glazed kitchen extension out of the ordinary by creating a worksurface which continues into the garden, creating a table.**

The house is late Georgian, located close to south London's Waterloo station. It is one of a terrace of cottage-style buildings, now grade II listed.

Azman Owens Architects' £70,000 brief was to refurbish the house. This centred on reorganising the central staircase, creating a service and circulation core. But more interesting is the addition of a glazed kitchen, squeezed between an existing extension on the rear of the house, and the house next door.

The single-storey new kitchen has a



PHOTOS: PAUL RATIGAN

double-glazed roof and rear wall. The kitchen units are lined along one side of the new room, ranged under a 5m limestone worktop in the kitchen. This surface continues outside, extending 1.5m into the garden over a fish tank. The worksurface is supported by the house's brick cavity wall, and by a concrete wall in the garden.

On a hot day, the client could eat off the counter in either the kitchen or the garden and not notice the difference.

*John Welsh*

## CREDITS

**Structural engineers** Richard Fryer Associates, Dewhurst MacFarlane

**Contractor** Varbud Construction

**Limestone worktop** Stone Age (reader enquiry no 101)

**Light fittings** Prolumena (enquiry no 102), Concord Lighting (enquiry no 103)

**Radiators** Radiating Style (enquiry no 104)

**Concrete pavers** Marshalls Mono (no 105)

Construction detail of cantilevered worktop.

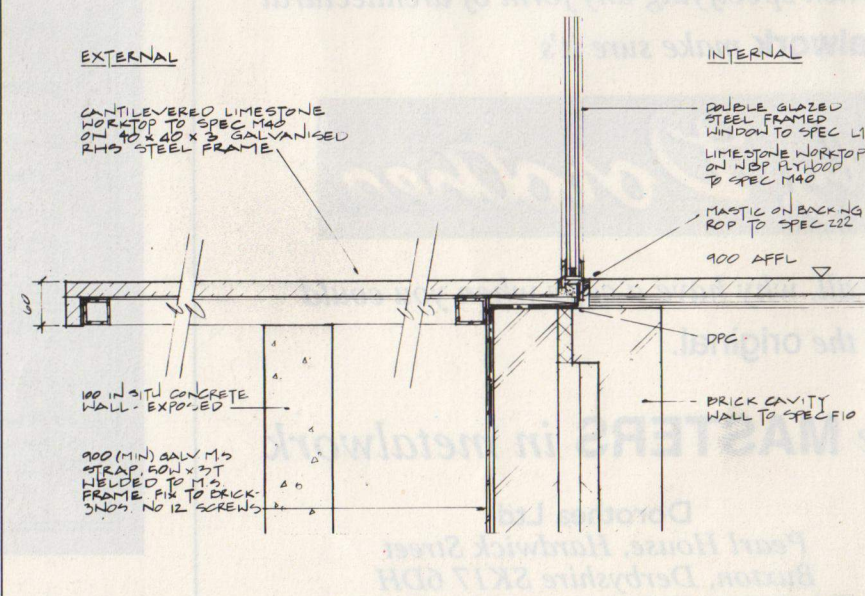

A kitchen extension resolves the problems of a terrace house (above), its limestone worksurface linking the interior to the garden (above, left).

**KEY TO GROUND FLOOR PLAN**  
1 Entrance  
2 Living room  
3 Core  
4 Dining room  
5 Kitchen  
6 Garden and terrace

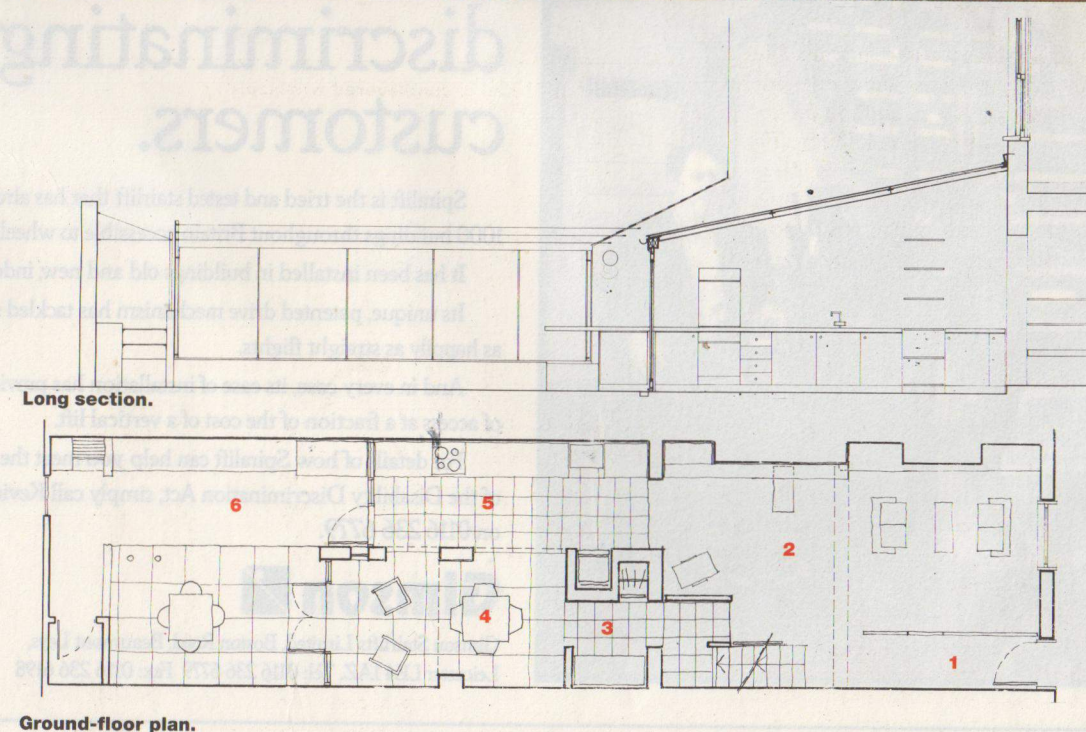

Ground-floor plan.